



Installation instructions
Monteringsvejledning
Monteringsanvisning



Installation - Brackets
Montering - Rørholdere
Montering - Hållare

Bracket 2150 after
laying of pipes

Rørholder 2150 monteres
efter at rørene er lagt

Hållare 2150 monteras
efter rördragning

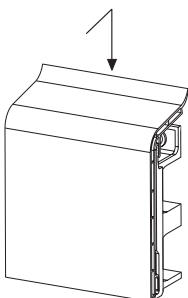
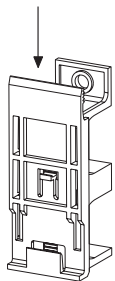
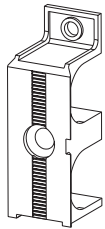
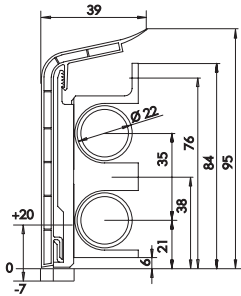

Bracket 2250 prior to
laying of pipes

Rørholder 2250 monteres før
rørene lægges

Hållare 2250 monteras
före rördragning

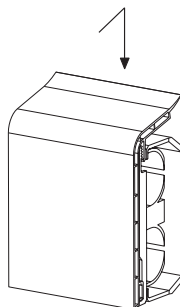
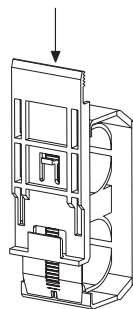
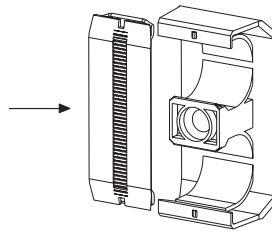
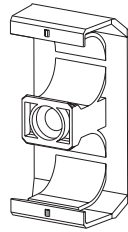
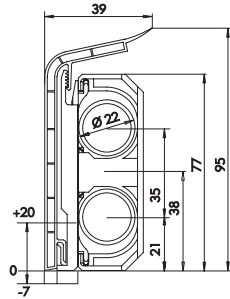

Bracket 2450 for pipes
up to 28 mm dia

Rørholder 2450 for rør
op til 2 x 28 mm

Hållare 2450 för rör
upp til 28 mm

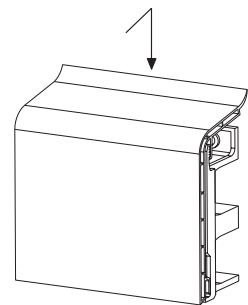
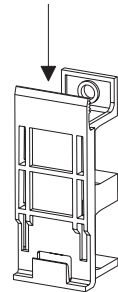
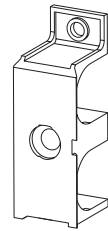
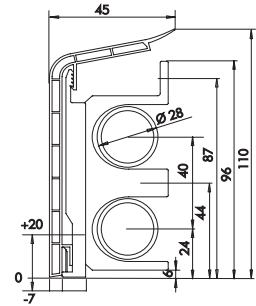



Installation

Corner brackets

Montering

Holdere for hjørne

Montering

Hörnhållare

Inner corner bracket 2151

Rørholder 2151
invendt hjørne

Hållare innerhörn 2151

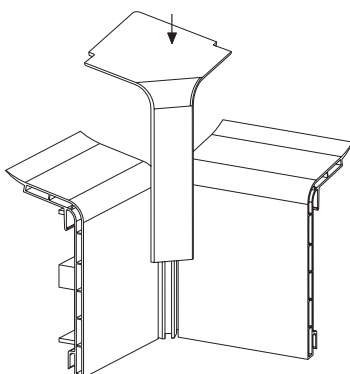
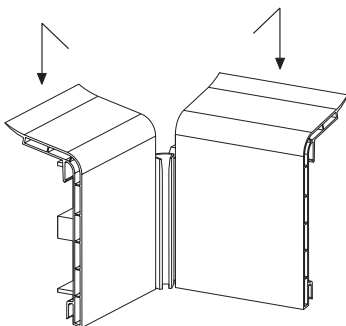
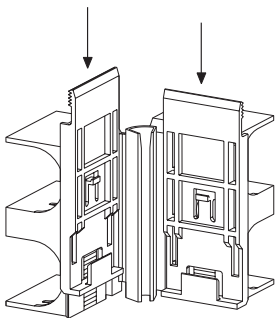
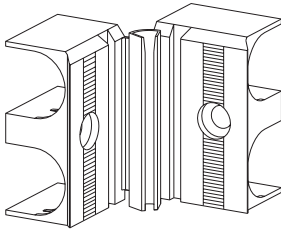
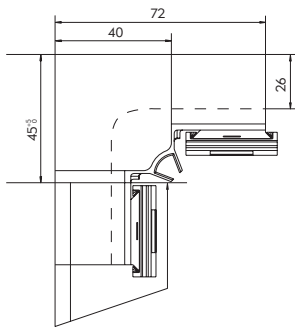

Outer corner bracket 2152

Rørholder 2152
udvendigt hjørne

Hållare ytterhörn 2152

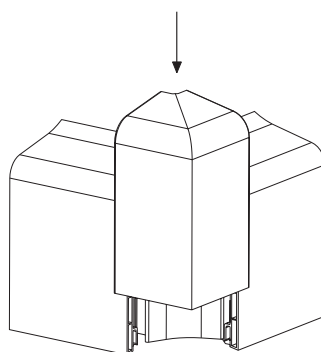
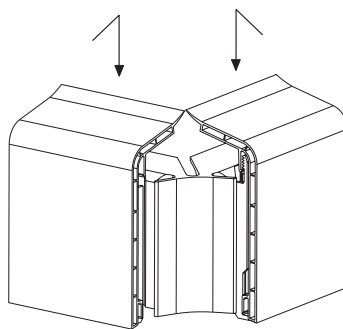
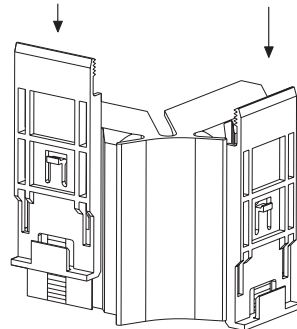
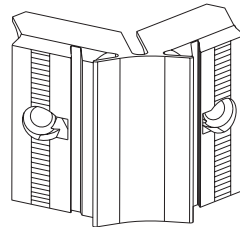
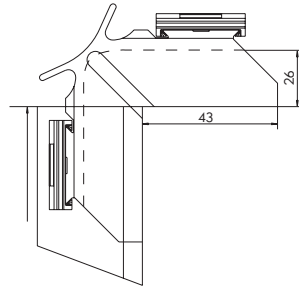

Use brackets as drill templates!
Rørholderen benyttes som bore-skabelon!
Hållaren används som bormall!



Installation - Skirting boards
Montering - Gulvpaneler
Montering - Golvsocket

Plastic skirting board for pipes up to 22 mm

Gulvpanel for rør op til 22 mm

Golvsocket för rör max 22 mm

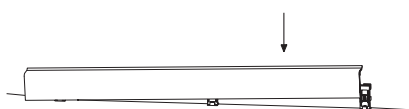
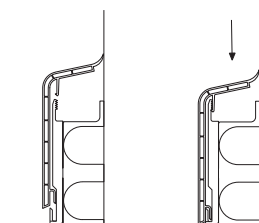
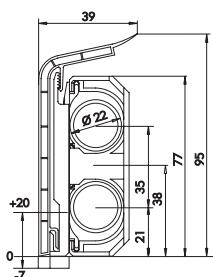

With inner corner bracket
 Med indvendig holder i hjørne
 Med hållare innerhörn

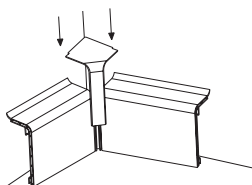

With outer corner bracket
 Med holder på udvendig hjørne
 Med hållare ytterhörn

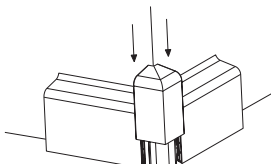

Corners for custom solutions

Hjørner for specialløsninger

Hörn för speciallösningar

Without inner corner bracket *

Uden rørholder

Utan hållare innerhörn

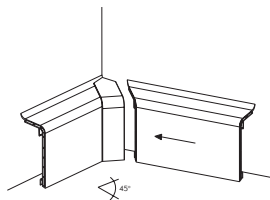

Without outer corner bracket *

Uden rørholder

Utan hållare ytterhörn

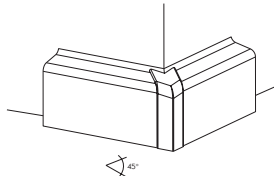

Carpet skirting board for pipes up to 22 mm

Gulvpanel for tæppekant for rør op til 22 mm

Golvsocket för heltäckningsmatta upp till 22 mm

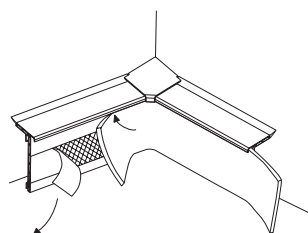
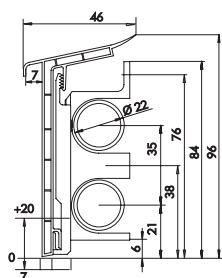

Please refer to the description on left or above for mounting with corner brackets or custom solution

Montering med rørholder eller specialløsninger som beskrevet ovenfor eller til venstre

Montage med hållare eller speciallösning som beskrivits ovan eller till vänster

Section for cable duct or 3rd pipe

Panel til el-kabel eller 3-rør

Golvsocket för 3-rør eller kabelkanal

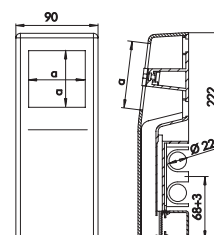
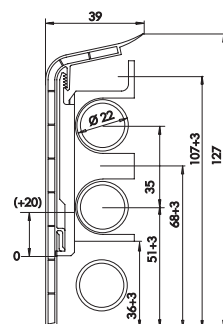

Type	Art. no.	Cut-out opening
Typenr.	Art. nr.	Udsnitts-åbning
Typ	Art. nr.	Urtag

62-62	331	62 x 62 mm
73-73	332	73 x 73 mm

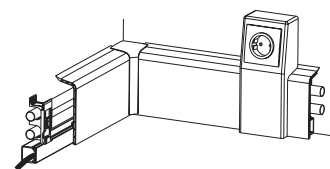
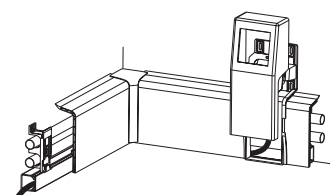
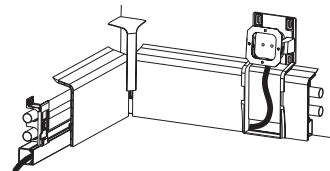
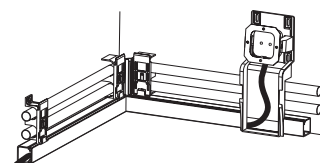
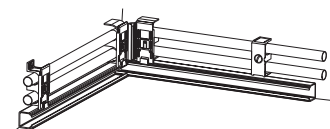

Solid wood skirting for pipes up to 18 mm

Massiv træpanel for rør op til 18 mm

Golvsockel massiv för rör upp till 18 mm

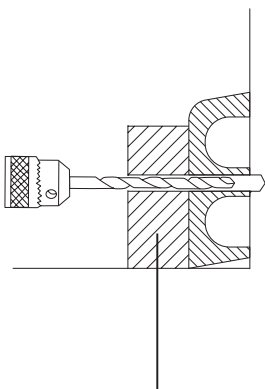
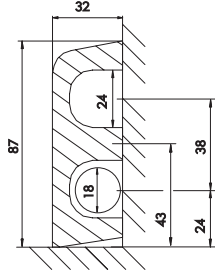

Drill template
Boreskabelon
Bormall

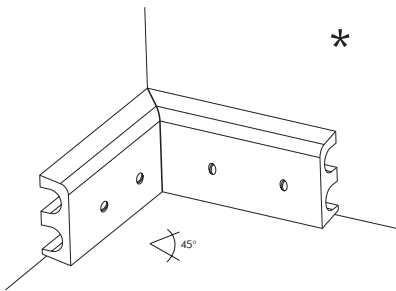

Plastic dummy skirting board
Blindprofil af kunststof
Blindlist

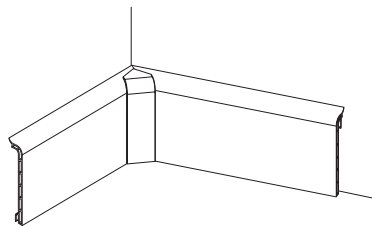
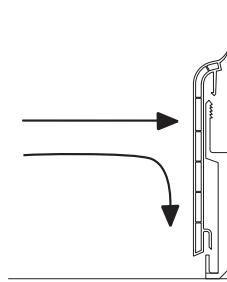
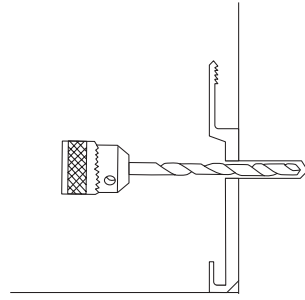
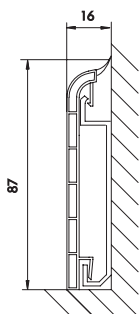

Plastic dummy skirting board for carpeting
Blindprofil for tæppekant af kunststof
Blindlist för heltäckningsmatta

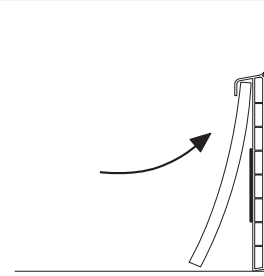
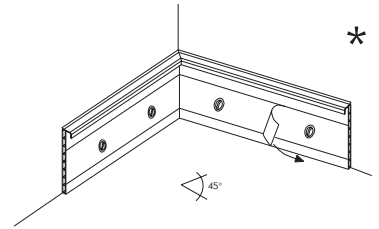
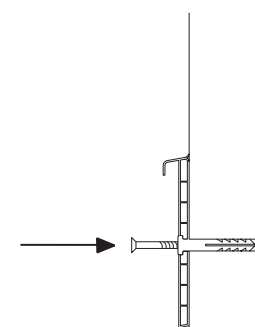
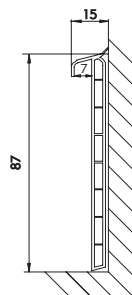

Solid wood dummy skirting board
Blindprofil af massiv træ
Blindlist massiv

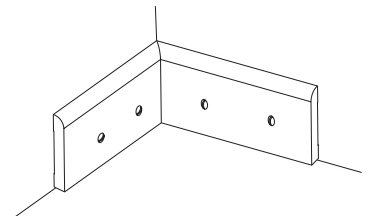
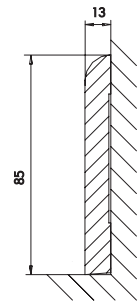

Transition from skirting board to dummy skirting board
Overgang fra gulvpanel til blindprofil
Övergång från golvsockel till blindlist

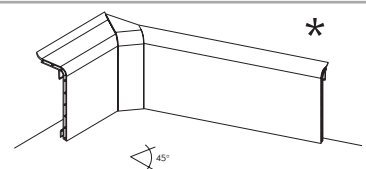
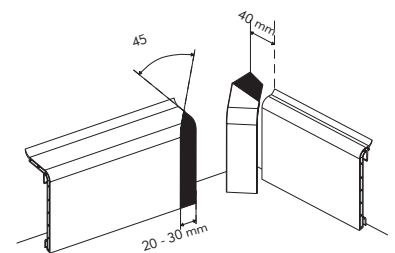

Single piece radiator connection (Solder)

Radiatortilslutning i eet stykke for lodning

Anslutningsset för lodning i ett stycke

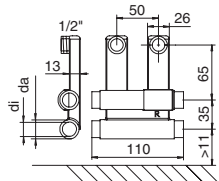

Art. no.	int. dia	ext. dia	Valve
Art. nr.	indv. dia	udv. dia	Ventil
Art. nr.	id	yd	ventil
1315L	15	18	←
1318L	18	22	←
1315R	15	18	→
1318R	18	22	→

← left-hand - Venstre - Vänster
→ right-hand - Højre - Höger

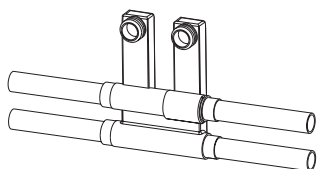

Two-piece radiator connection *
(Solder, press, screw)

Radiatortilslutning 2-delt
(Lodde, press, klemring)

Anslutningsset tvådelad
(Lödning, pressing, klämring)

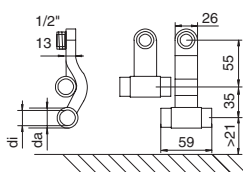

Art. no.	int. dia	ext. dia
Art. nr.	indv. dia	udv. dia
Art. nr.	id	yd
1015	15	18
1018	18	22

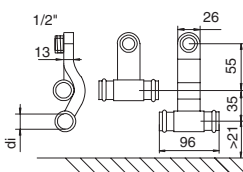

Art. no.	int. dia
Art. nr.	indv. dia
Art. nr.	id
1515	15
1518	18

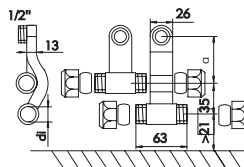

Art. no.	int. dia	a
Art. nr.	indv. dia	a
Art. nr.	id	a
1115	15	55
1118	18	55
2115	15	107
2118	18	107

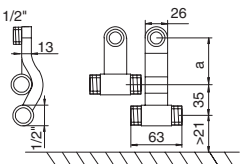

Art. no.	int. dia	a
Art. nr.	indv. dia	a
Art. nr.	id	a
1215	1/2"	55
2215	1/2"	107

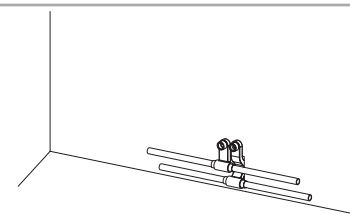
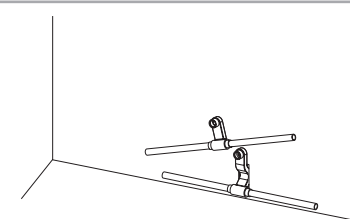
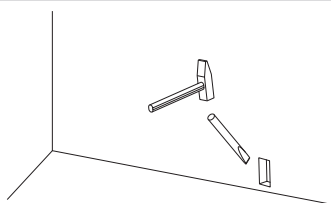

90° elbow with shut off valve, to suit connections to compression joints / 90° bends, to suit connections to compression joints *

Pasbøjninger

Anslutningsrør med avstängning / kopplingsrør

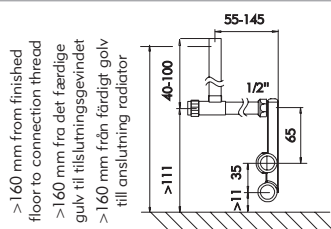

Calculate height + depth; shorten; install with compression joint

Tilpasses efter højde og dybde; monteres med klemringsforskruing

Anslutningsrør kapas före montage



Installation

Radiator connections, 90° elbow with shut off valve, to suit connections to compression joints / 90° bends, to suit connections to compression joints

Montering

Radiatortilslutninger, og pasbøjninger

Montering

Anslutningsset, anslutningsrør med avstängning och kopplingsrør

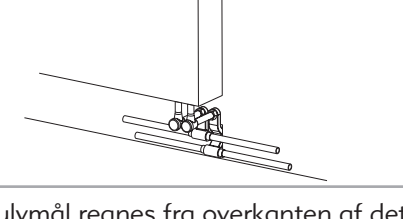
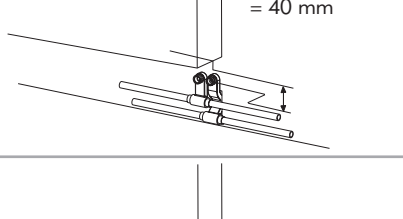
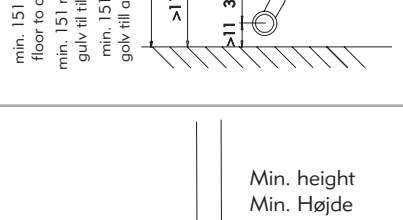
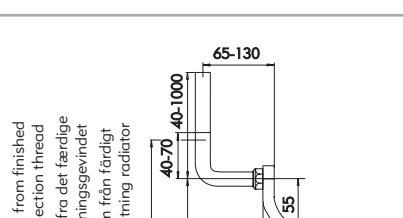
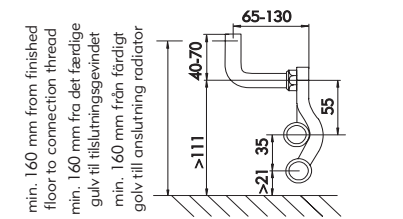
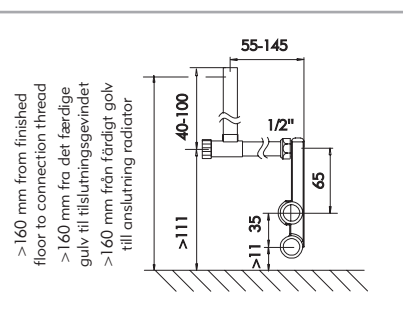

Min. height
Min. Højde
minimihøjde
= 40 mm

U-shaped plastic riser sections

Stigestrengsprofil af kunststof i U-Form

Stamledningsprofil U-profil

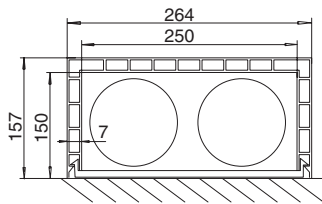
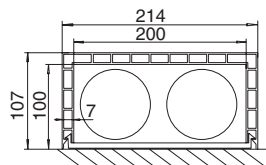
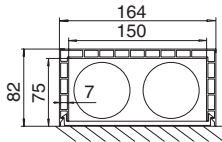
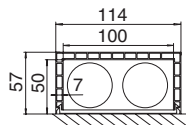

L-shaped plastic riser sections

Stigestrengsprofil af kunststof i L-Form

Stamledningsprofil L-profil

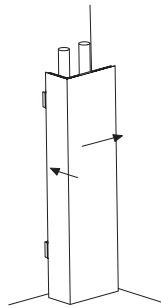
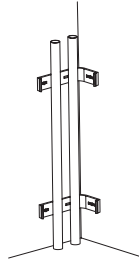
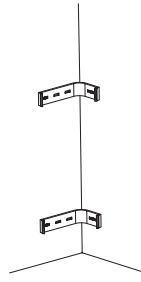
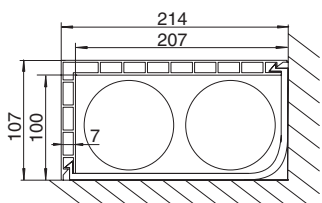
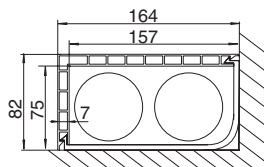

L-shaped plastic riser sections (6480)

Stigestrengsprofil af kunststof i L-Form (6480)

Stamledningsprofil L-profil (6480)

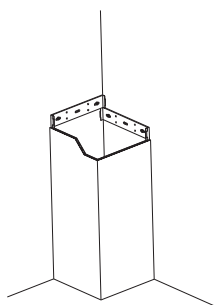
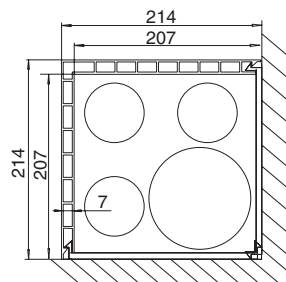

Installation

U-shaped and L-shaped plastic riser sections

Montering

Stigestrengsprofil af kunststof U-Form/L-Form

Montering

Stamledningsprofil U och L-profil

Accessories for riser system

Tilbehør til Stigestrengssystem

Tillbehör för stamledningsprofil

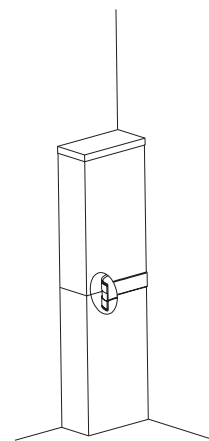
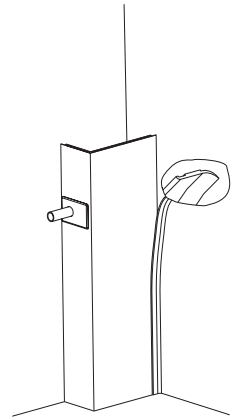

Summary

Kvik-Information

Lämplig kombination

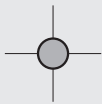

possible, available, suitable
Passende for
passar till

Plastic skirting board for pipes up to 22 mm
Rørpanel af kunststof for rør op til 22mm
Golvsoclel rør max. 22 mm

Carpet skirting board for pipes up to 22 mm
Rørpanel med tæppekant for rør op til 22mm
Golvsoclel helt matra rør max 22 mm

Section for cable duct or 3rd pipe
Rørpanel med EL-Kabelkanal eller plads for 3. rør
Golvsoclel 3 rør eller kabelkanal

Plastic skirting for pipes up to 28 mm
Rørpanel af kunststof for rør op til 28 mm
Golvsoclel 28 mm rør

Solid wood skirting for pipes up to 28 mm
Ægte træpanel for rør op til 28 mm
Golvsoclel massiv for rør max. 28 mm

Plastic dummy skirting for pipes up to 18 mm
Blindprofil for rør op til 18 mm
Blindlist

Plastic dummy skirting board
Blindprofil helt tækkingsmatta

Solid wood dummy skirting board
Blindprofil af ægte træ
Blindlist massiv

Maple, beech light and dark, white ash, dark oak Ahorn, lys eller mørk bøg, hvid lud, mørk eg. Lønn, Bok ljus och mörk, Ask vit, Ek mørk	●					●		
Light oak, white Lys eg, hvid Ek ljus, Vit	●	●	●	●		●	●	
Grey Grå Grå	●		●			●		
Bracket 2150, 2250 Holder 2150, 2250 Hållare 2150, 2250	●	●	●					
Bracket 2450 Holder 2450 Hållare 2450				●				
Inner corner bracket 2151, outer corner bracket 2152 Indvendigt hjørne 2151, udvendigt hjørne 2152 Hållare Innerhörn 2151, Ytterhörn 2152	●	●	●					
Dummy skirting board holder 155 Blindprofilholder 155 Blindlisthållare 155						●		
Attach with nail plug or cheese-head screw Montering med rawplugg eller linsehovedskrue Montering med Skruv/Rawplugg eller kullerforsänkt skruv						●	●	●
Inner and outer corner for corner brackets Indvendigt- og udvendigt hjørne for hjørne holder Inner- och ytterdel för hörn	●	●	●					
Inner and outer corner for custom solutions Indvendigt- og udvendigt hjørne for specialløsninger Inner- och ytterhörn för speciallösningar	●	●	●	●		●		
Butt joints Samlestykke Skarstykke	●	●	●	●		●		
End pieces Endestykke Ändestykke	●	●	●	●	●	●		
Suitable for HZ radiator connector Egnet for HZ- radiator Slutninger Avsedd för HZ anslutningsset	●	●	●	●				
Sealing lip towards wall Tætningslæbe mod væg Mjuk tättningslist mot vägg	●	●	●	●		●	●	
Matching socket housing Egnet for brug sammen med EL- stikkdåse Passar för vägguttag			●					

Hans Weitzel KG
Konrad-Adenauer-Straße 20
D-55218 Ingelheim



www.hz-weitzel.de
export@hz-weitzel.de

Telefon +49 (0) 6132 / 790 89 -10
Telefax +49 (0) 6132 / 7836 -10